

RIDGE INSTALLATION

RECOMMENDED GUIDELINES TO INSTALL THE RIDGE TILE:

- INSTALL 2½" X 1½" HORIZONTAL WOOD BATTEN AT THE HIGHEST POINT OF THE ROOF TO ALIGN THE RIDGE.
- FILL IN WITH MORTAR AS NECESSARY ON THE SIDE OF THE BATTENS IN ORDER TO PLACE THE RIDGE TILE.

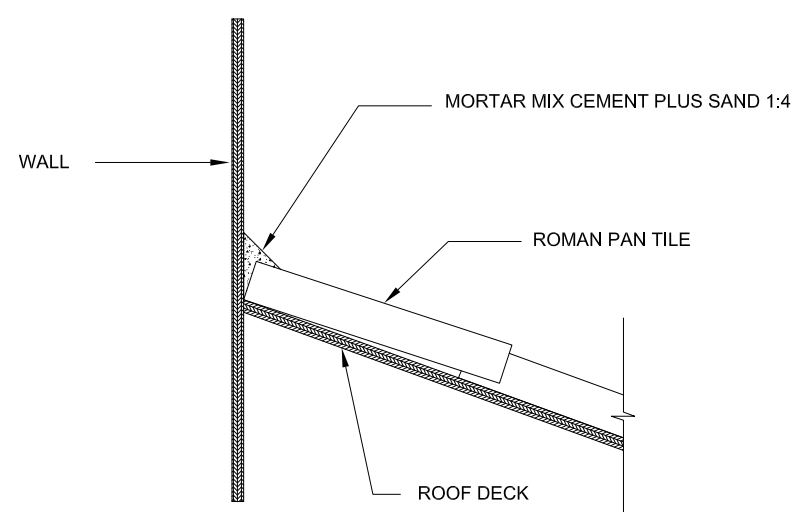
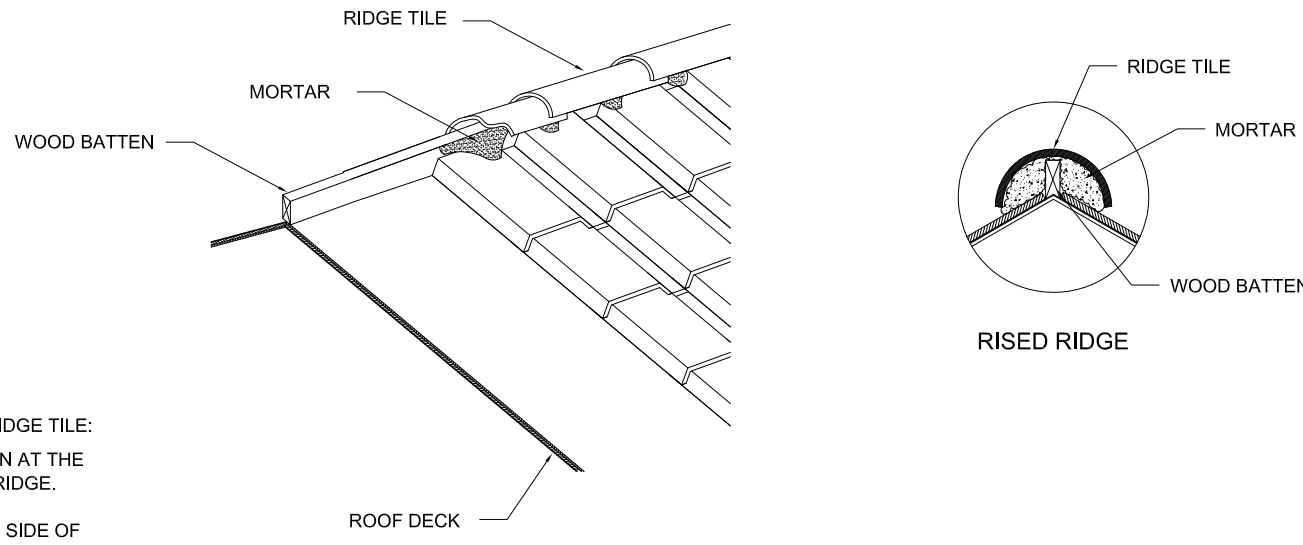

ROOF-TO-UPPER WALL FINISHED DETAIL MORTAR

IN ORDER TO HAVE BETTER SEALING RESULTS, IT IS RECOMMENDED TO PLACE MORTAR AT THE WALL AND TILE JOINT, AS SHOWN

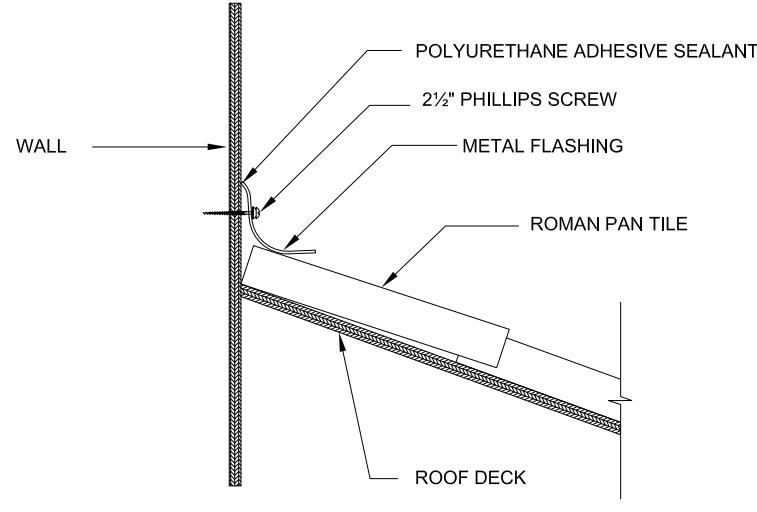

ROOF-TO-UPPER WALL FINISHED DETAIL METAL FLASHING

TO ENSURE PROPER SEALING, INSTALL METAL FLASHING AS SHOWN. USE 2½" PHILLIPS SCREW AND SEAL WITH POLYURETHANE ADHESIVE SEALANT AT JOINT BETWEEN FLASHING AND WALL.

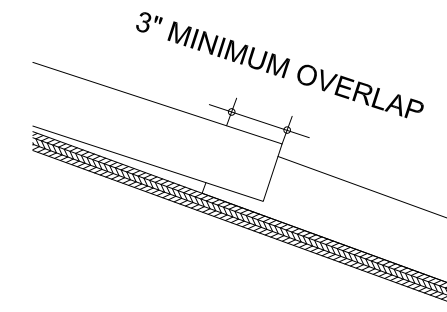

HORIZONTAL COURSE OVERLAP

OVERLAP WILL VARY DEPENDING ON THE ROOF DIMENSIONS AND SHAPE. A 3" MINIMUM OVERLAP IS REQUIRED.

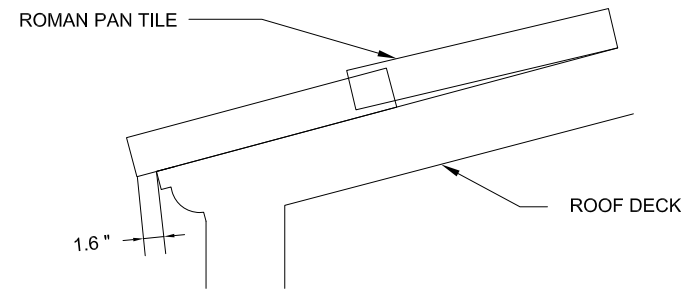

EAVE DETAIL

- THE FIRST COURSE LINE WILL NEED A MINIMUM OF 1.6" OVERHANG.

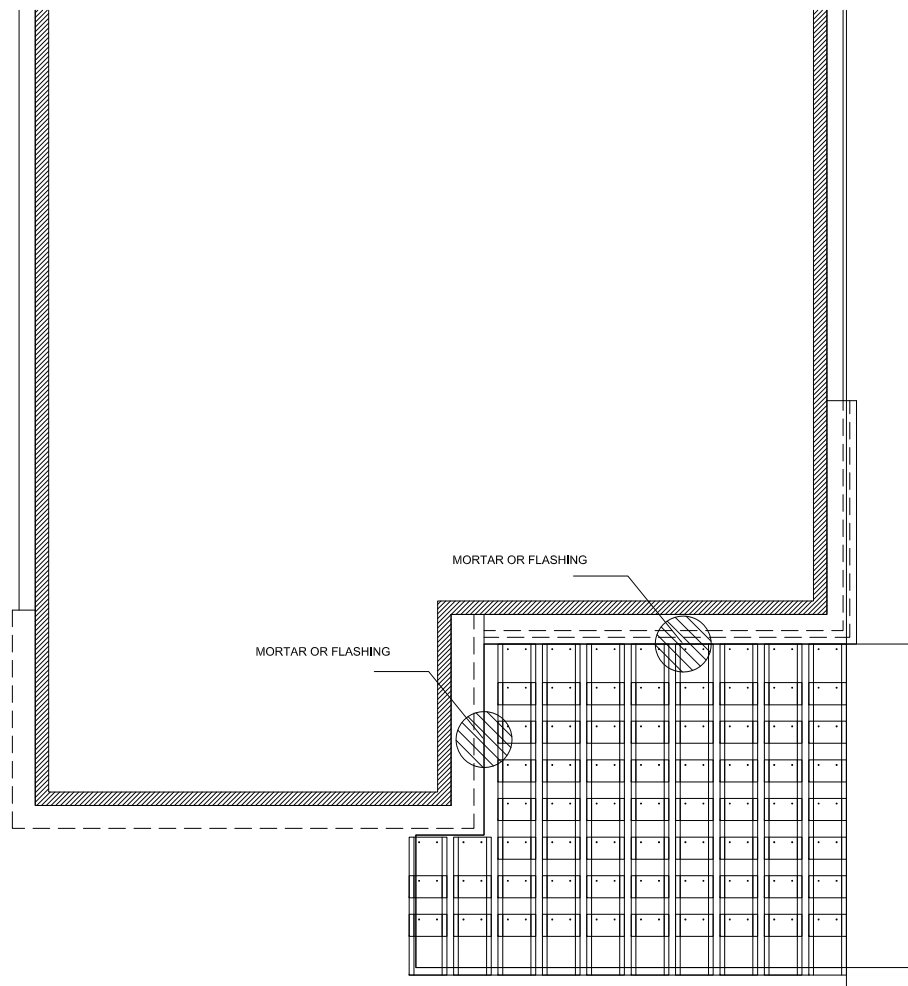

QUANTITY OF TILE PIECES		
TILE PROFILE	DIMENSION	NUMBER OF TILE PIECES
ROMAN PAN	17.75" X 11"	132

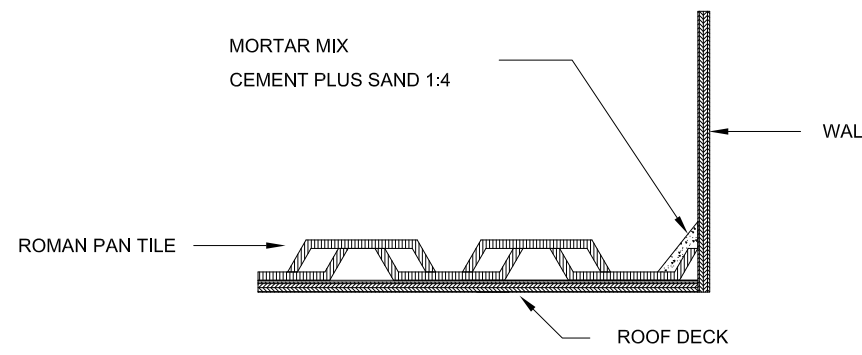
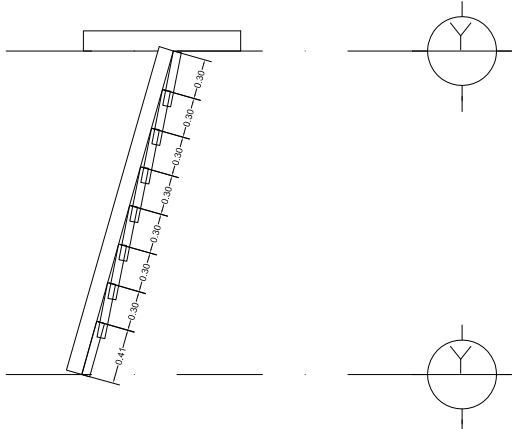

ROOF-TO-SIDE WALL FINISHED DETAIL MORTAR

TO ENSURE PROPER SEALING, APPLY MORTAR AT WALL AND TILE JOINT, AS SHOWN IN THE DRAWING.

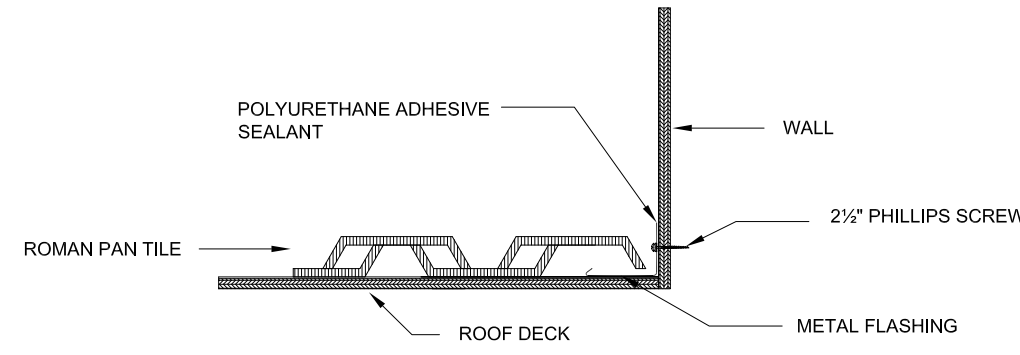

ROOF-TO-SIDE WALL FINISHED DETAIL METAL FLASHING

TO ENSURE PROPER SEALING, IT IS RECOMMENDED TO INSTALL A METAL FLASHING, AS SHOWN IN THE DRAWING. USE 2 ½ PHILLIPS SCREW AND FINISH WITH POLYURETHANE ADHESIVE AT FLASHING AND WALL JOINT.

RAKE TILE FASTENING DETAIL

FOR THE RAKE TILE AT SIDEWALL, PLACE FIRST A 3" X 2" WOOD BATTEN, AS SHOWN IN THE DRAWING. AFTER FASTEN THE RAKE TILE USING A 2" SHANK FLAT HEAD ROOFING NAIL TO THE WOOD BATTEN. PLACE THE TILE OVER THE BATTENS AND THE RAKE TILE AT SIDEWALL.

NOTE: IN ORDER TO AVOID WATER INFILTRATIONS AND/OR OTHER ROOF DAMAGE, IT IS RECOMMENDED TO USE ROOF ADHESIVE TO FASTEN THE WOOD BATTEN TO THE ROOF DECK.

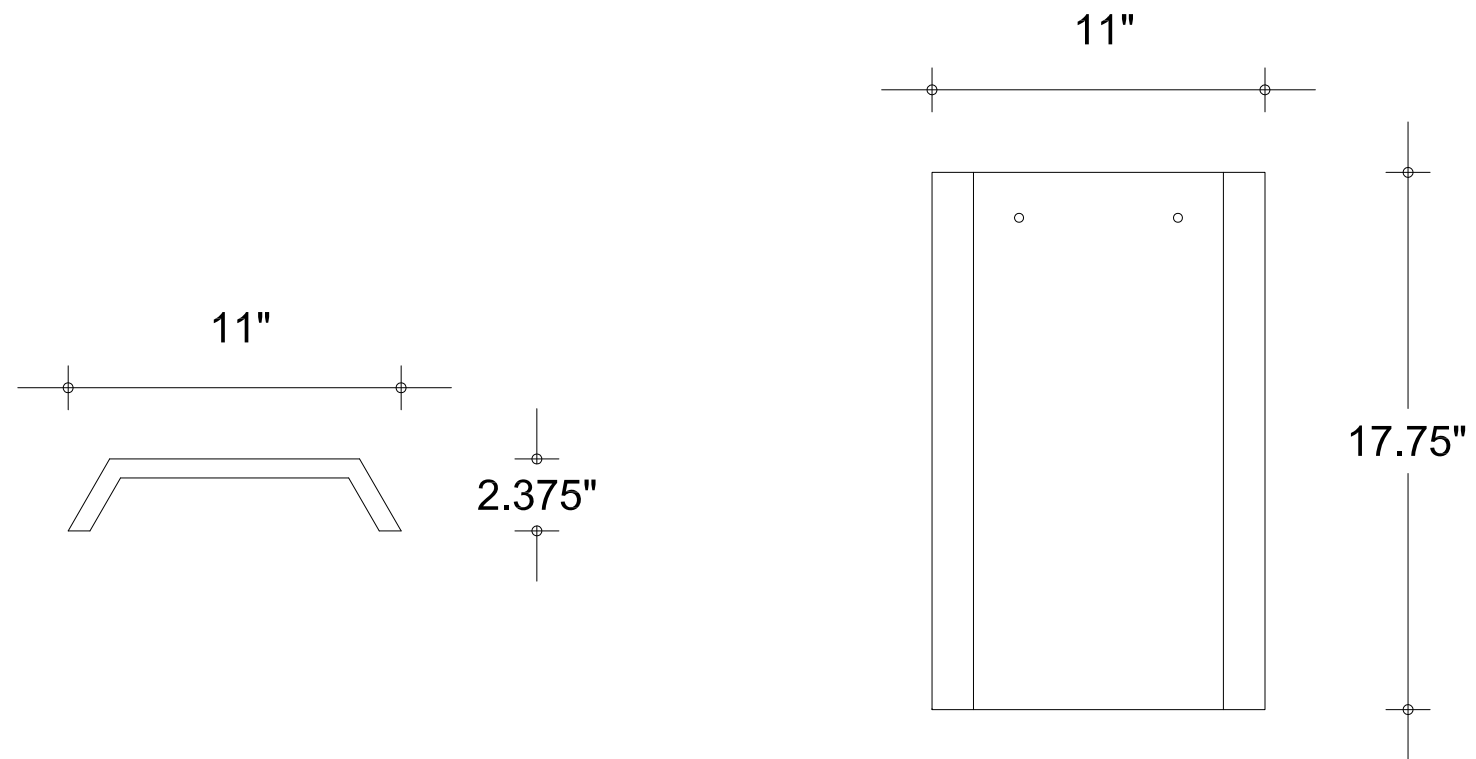
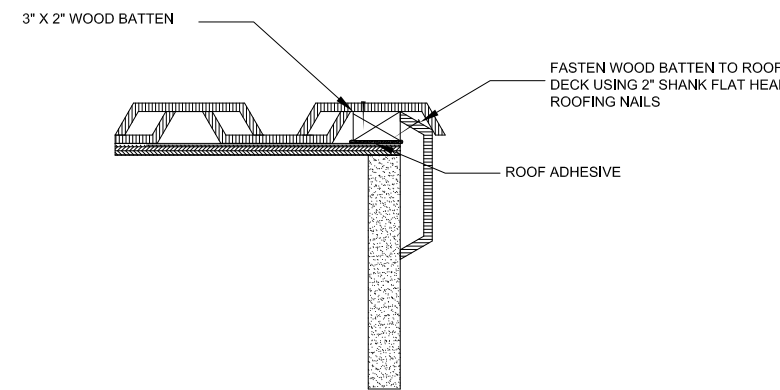

ROMAN PAN TILE

RAMON PAN TILE SPECIFICATIONS

THIS TILE IS MADE OF CLAY, PIGMENTS AND AGGREGATES.

COLOR	-----	VARIABLES
WIDTH	-----	11 INCHES
LENGTH	-----	17.75 INCHES
THICKNESS	-----	0.625 INCH
HEIGHT	-----	2.275 INCHES
WEIGHT PER TILE	-----	6.6 LBS.
WEIGHT PER SQUARE	-----	1000 LBS.
PIECES PER SQUARE	-----	152
RESISTANCE PER PIECE	-----	440 LBS.

ROMAN PAN TILE MIGHT BE INSTALLED USING DIFFERENT FASTENING SYSTEMS ACCORDING TO THE TILE PROFILE AND WIND AREA.

MINIMUM RECOMMENDED SLOPE FOR BEST WATERPROOFING SYSTEM RESULTS: 2:12, WITH A MINIMUM OVERLAP OF 3 INCHES.

THESE VALUES AND DRAWINGS SHOWN ARE INTENDED FOR REFERENCE AND MAY VARY FROM CASE TO CASE. REDLAND CLAY TILE EXPRESSLY DISCLAIMS ANY WARRANTIES EXPRESSED OR IMPLIED BY ANY INFORMATION HEREIN.

INSTALLATION NOTE

APPLY POLYURETHANE FOAM TO FASTEN THE TILE TO THE ROOF DECK, ESPECIALLY IN MODERATE WIND REGIONS. FOLLOW THESE RECOMMENDATIONS:

UPSIDE DOWN TILE:

- APPLY ONE SHOT OF 10" X 2" LONG APPROXIMATELY, SET THE TILE OVER SO THE FOAM EXPANDS AND ATTACHES THE TILE COMPLETELY.

COVER TILE:

- APPLY TWO SHOTS OF 10" X 1" LONG ON EACH SIDE OF THE TILE AND PLACE THE COVER TILE AS SHOWN IN THE DRAWING.

PROJECT SCOPE: FASTENING OF TILES AROUND THE ROOF'S PERIMETER AND FIELD OVERLAPPING TILES WITH THE USE OF FOAM.

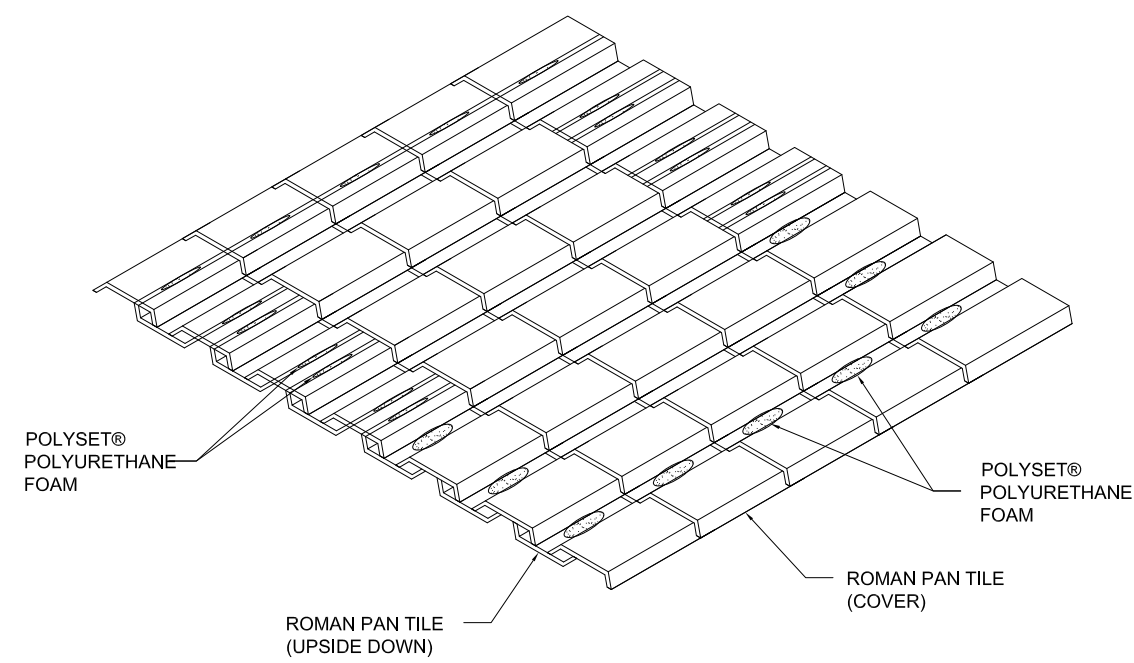

FASTENING OPTION: POLYURETHANE FOAM

INSTALLATION NOTE

FOR MORTAR FASTENING IN MODERATE WIND REGIONS, USE A MIX OF CEMENT PLUS SAND (1:4) AND FOLLOW THESE RECOMMENDATIONS:

ROMAN PAN TILE (UPSIDE DOWN):

- APPLY A 10" X 4" LINE OF MORTAR BETWEEN TILE AND ROOF DECK AS SHOWN IN SUCH MANNER THAT THE TILE LIES COMPLETELY OVER THE MORTAR MIX.

ROMAN PAN TILE (COVER):

- INSIDE OF EACH PAN TILE, APPLY A 10" LONG LINE OF MORTAR, PLACE COVER TILE LYING COMPLETELY OVER THE MORTAR MIX.

PROJECT SCOPE: FASTENING OF TILES AROUND THE ROOF'S PERIMETER AND FIELD OVERLAPPING TILES WITH THE USE OF FOAM.

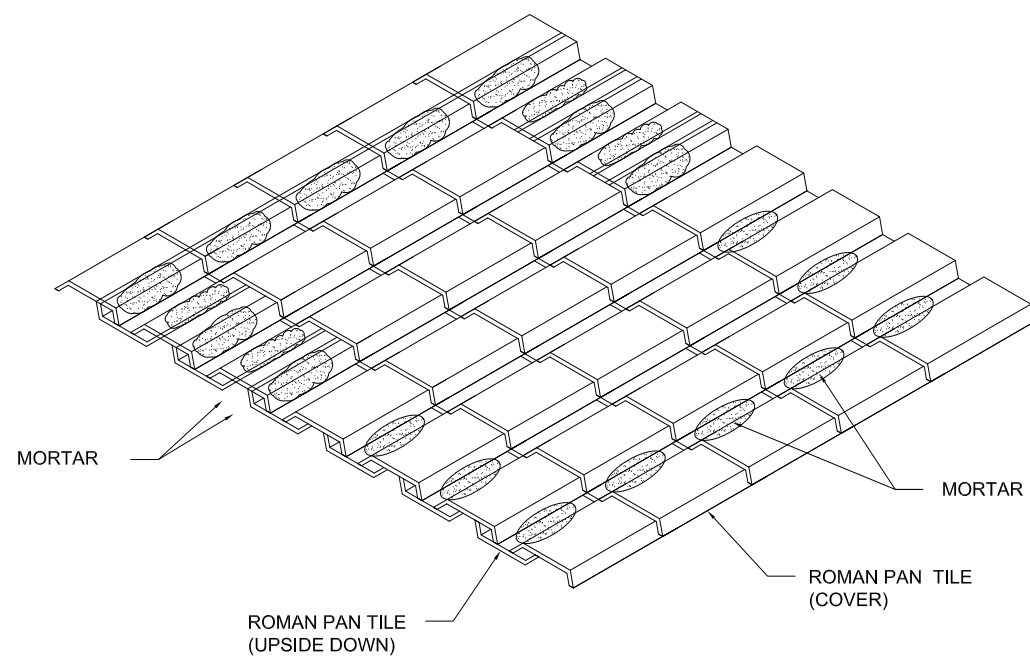

FASTENING OPTION: MORTAR

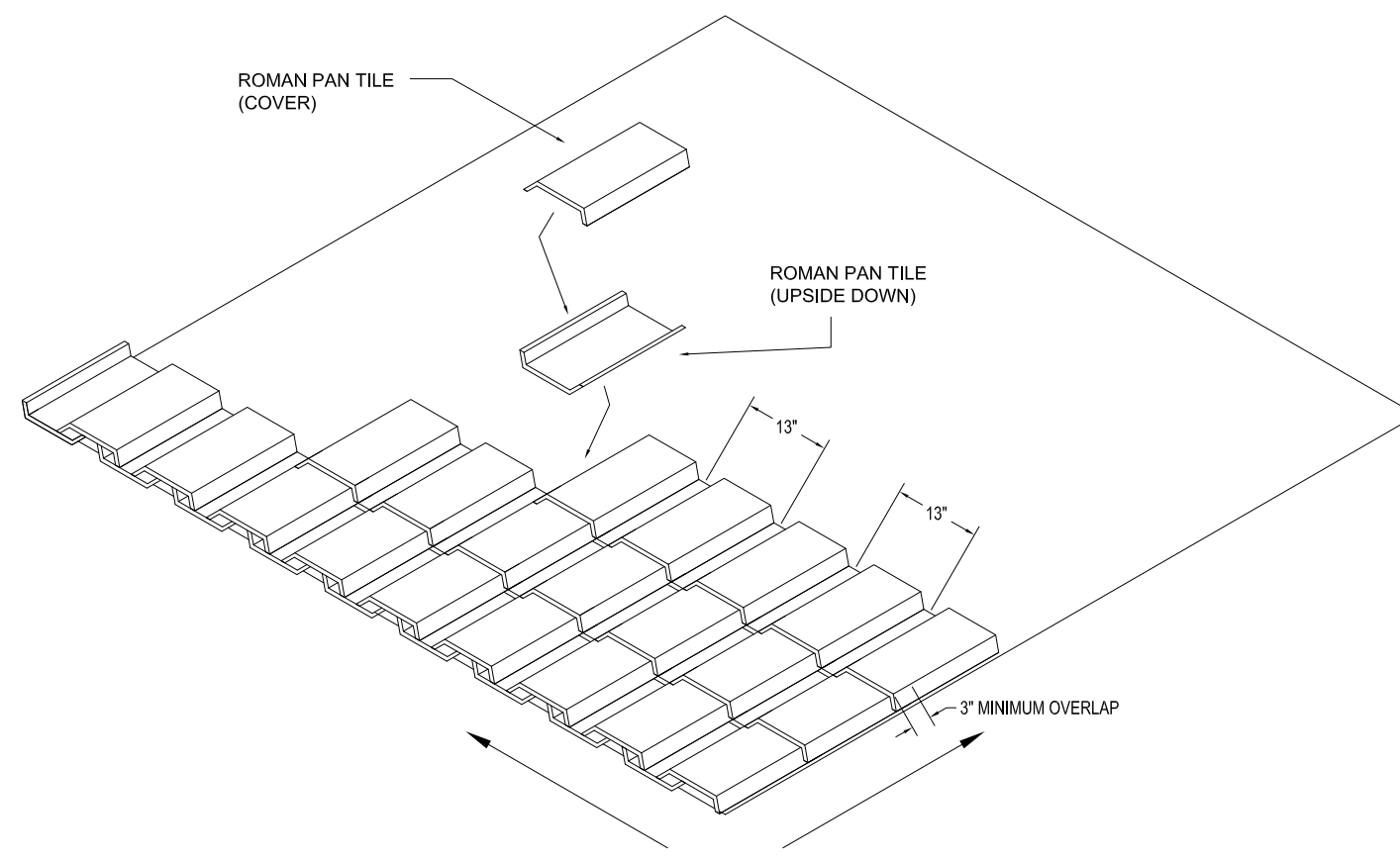

ROMAN PAN TILE LAYOUT

ROMAN PAN TILE LAYOUT STARTS FROM BOTTOM TO TOP, RIGHT TO LEFT (IT CAN ALSO BE LEFT TO RIGHT), LAYING DOWN COMPLETE COURSES AS SHOWN IN THE DRAWING.

IT IS RECOMMENDED TO MARK VERTICAL LINES EVERY 13" ON CENTER FROM CAP TILE TO TILE BASE, IN ORDER TO OBTAIN BETTER LAYOUT AND DISTRIBUTION.

A MINIMUM 3 INCH OVERLAP MUST BE MAINTAINED FOR EACH TILE.

FOR BEST WATERPROOFING RESULTS, IT IS RECOMMENDED A MINIMUM SLOPE OF 2:12 OR LOW ROOF.

PENDIENTE RECOMENDADA DE LAS LOSAS PARA EL ADECUADO FUNCIONAMIENTO DEL SISTEMA IMPERMEABLE DEL TEJADO: 10°